



# FIBER LASER CUTTER



Nanjing RONGWIN Machinery Technology Co., Ltd.  
Mastering Metal, Shaping Futures

# About Us

## Values:

Customer Obsession  
Gratitude in Action  
Uncompromising Integrity

Future-Ready  
Outcome Architects

Collaborative Excellence  
Relentless Growth  
Thriving Together

## Our Company



### Our Company

Nanjing RONGWIN Machinery Technology Co., Ltd., with 15+ years of expertise, is a global leader in press brakes factory and custom smart metal automation solution supply Chain Supplier. Known for reliability and 85%+ customer satisfaction, we also deliver customized machinery, spare parts, equipment upgrades & renovations and promise lifetime service support.

In 2022, we launched MetalworkMaster, integrating Industry 4.0 intelligence for custom smart metal automation solutions. Our "Win-Win" philosophy drives innovation, including IoT-connected press brakes, enhancing efficiency, precision, and sustainability. Serving 150+ countries across six continents, RONGWIN empowers clients with energy-saving, high-performance solutions—shaping the future of smart manufacturing.

### Our Mission

Innovating intelligent metal processing technologies, we co-create customized solutions with global clients, backed by lifetime commitment to their operational excellence.

## Why Us?



Lifetime Service Promise



Flexible Customization Support



82% Repeat Purchase Rate



15 years press brake manufacturing experience

2009

2025

2009

Started in press brake/shearing machines, developed 10+ machine types and spare parts business, plus import-export operations.

2017

RONGWIN, founded by Jane Wu, built an advanced service system and adopted modern management.

2020

RONGWIN boosted global reach, entering emerging markets and exporting to 150+ countries.

2021

We self owned full series precision press brake factory, a full set of metal processing automation supply chain and quality control system.

2022

We introduced 'Metalworkmaster'—delivering smart, custom sheet metal solutions globally with lifetime support for Industry 4.0.

2023

RONGWIN marked its 6th year with expanded market share and higher customer satisfaction.

2025

RONGWIN continues to innovate, developing intelligent metalworking solutions and expanding its product range with advanced Press Brakes, reinforcing its industry leadership.

## Our Factory



**Our Vision:** Redefining the metal processing landscape as a trusted partner, where smart customization and lifelong collaboration shape industry excellence

**RONGWIN: Mastering Metal, Shaping Futures**

# Reliable



24 / 7 technical support | Fast supply of spare parts | Lifetime service

**MACHINERY DIRECTIVE,  
ELECTROMAGNETIC COMPATIBILITY DIRECTIVE  
ATESTATION OF CONFORMITY**

Technical file of the company mentioned below has been inspected and audit has been completed successfully.  
2006/42/EC Machinery Directive has been and 2014/30/EU Electromagnetic Compatibility has been taken as references for these processes.

Company Name : **NANJING RONGWIN MACHINERY TECHNOLOGY CO., LTD**

Company Address : Technology And Innovation Center, Lishui Industry New Town, Lishui Economic Development Zone, Nanjing, Jiangsu, China

Related Directives and Annex : **2006/42/EC Machinery Directive / Annex VIII  
2014/30/EU Electromagnetic Compatibility Directive / Annex II**

Related Standards : **EN ISO 12100:2010; EN 60204-1:2018; EN 61000-6-4:2019  
EN IEC 61000-3-2:2019-A1:2021; EN 61000-6-2:2019**

Product Name : **Laser Cutting Machine**

Report No and Date : **NJRW24011801-MDEMC**

Product Brand/Model/Type : **RWL-3015R, RWL-4015R, RWL-6015R, RWL-4020R, RWL-6020R, RWL-6322B, RWL-6025R, RWL-8322B, RWL-8325B, RWL-12022B, RWL-12322B, RWL-13025R, RWZ-3015R, RWZ-4015R, RWZ-6015R, RWZ-4020R, RWZ-6020R, RWZ-6322B, RWZ-6025R, RWZ-8322B, RWZ-8325B, RWZ-12022B, RWZ-13025R, RWZL-3015R, RWZL-4015R, RWZL-4015R, RWZL-4020R, RWZL-6020R, RWZL-6322B, RWZL-6025R, RWZL-8322B, RWZL-8325B, RWZL-12022B, RWZL-13025R, RWL-G-3015G, RWL-G-4015G, RWL-G-6015G, RWL-G-4020G, RWL-G-6020G, RWL-G-6025G, RWG-4000G, RWG-6000G, RWG-8000G, RWG-12000G, RWG-16000G**

Certificate Number : **M.2024.206.C96063**

Initial Assessment Date : **23.01.2024**

Registration Date : **24.01.2024**

Reissue Date/No : **-**

Expiry Date : **23.01.2029**

UDEM International Certification Auditing Training Centre Industry and Trade Inc. Co. Mustafa MEM-CO-111 General Manager

Address: Mithakent Mahallesi 2073 Sokak (Eski H) Sokakı No:10 Çankaya Ankara - TÜRKİYE  
Phone: +90 312 443 03 90 Fax: +90 312 443 03 78  
E-mail: info@udem.com.tr www.udem.com.tr

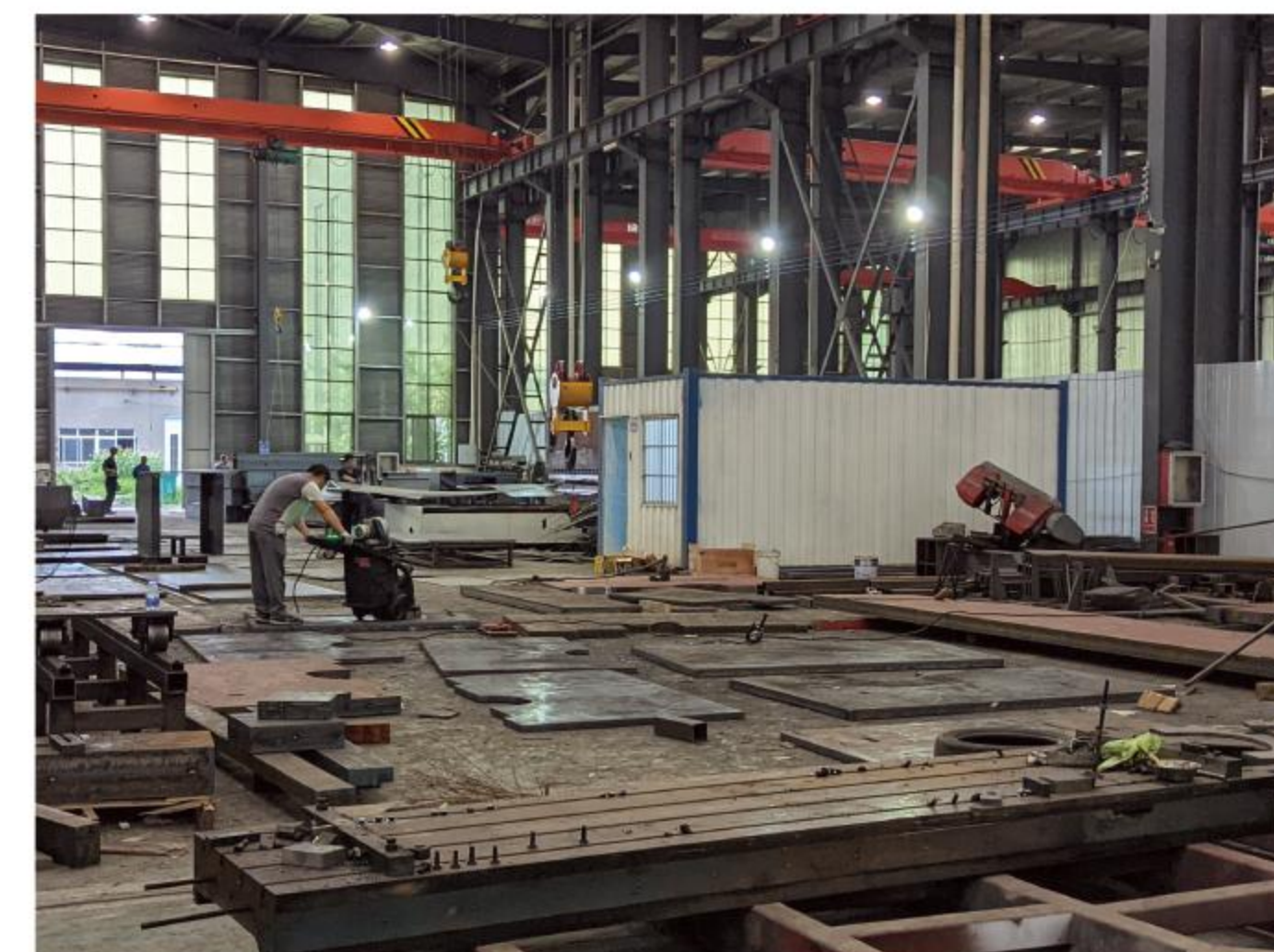
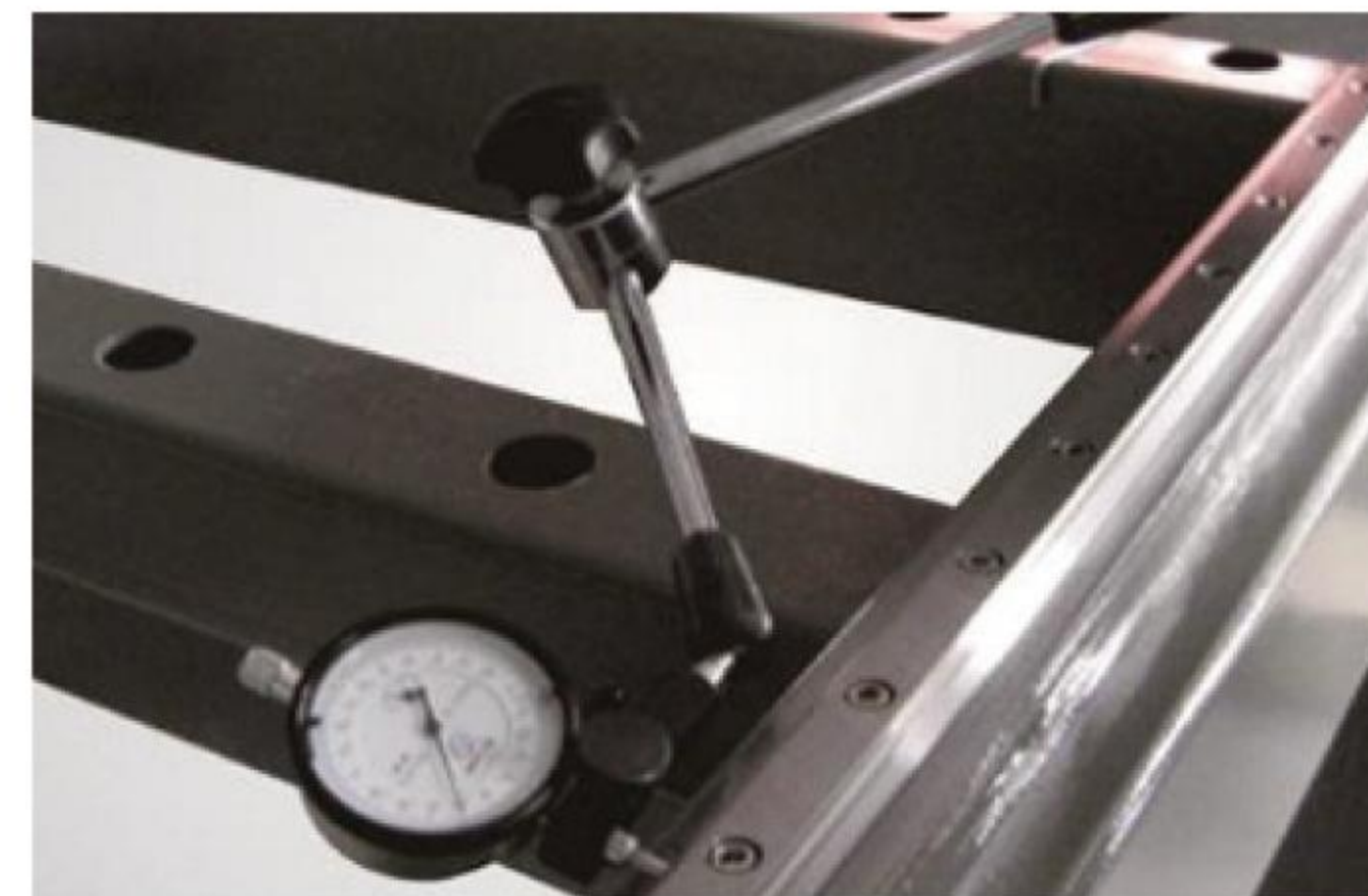

# FIBER LASER CUTTER

Double Drive

RWL SERIES

Open Type

Feature

- Gantry double drive structure, good rigidity and stable operation
- Fuselage steel plate is welded and annealed in large tempering furnace.
- The whole machine adopts open integrated design which is convenient for installation, loading and unloading, and can be transferred without debugging. The 1500mm model can be directly put into the container.
- Advantages: maintenance-free, low cost, strong function, high stability and economic benefits

## Product Parameter List

Type	RWL-3015B	RWL-4015B	RWL-4020B	RWZ-6015B	RWL-6020B	RWL-6322B	RWL-6325B	RWL-8322B	RWL-8325B	RWL-13025B
Processing range	3000*1500mm	4000*1500mm	4000*2000mm	6000*1500mm	6000*2000mm	6300*2200mm	6300*2500mm	8300*2200mm	8300*2500mm	13000*2500mm
X-axis travel	1500mm	1500mm	2000mm	1500mm	2000mm	2200mm	2500mm	2200mm	2500mm	2500mm
Y-axis travel	3000mm	4000mm	4000mm	6000mm	6000mm	6300mm	6300mm	8300mm	8300mm	13000mm
Z-axis travel	140mm									
Laser power (W)	1500/2000/3000/4000/6000/8000/10000/12000/15000/20000/30000/others									
X/Y-axis positioning accuracy	≤ ±0.03mm									
X/Y-axis repeat positioning accuracy	≤ ±0.02mm									
Maximum positioning speed	120m/min									

# FIBER LASER CUTTER

Double Drive

**RWZ SERIES**

Open Type Exchange Table

## Feature

- The whole machine adopts open split design.
- Exchange platform to save loading and unloading time and meet customers' continuous cutting needs.
- Adopts traditional stable gantry structure and high-strength cast aluminum alloy beam.
- Mature processing system and user-friendly operation software.

## Product Parameter List

Type	RWZ-3015B	RWZ-4015B	RWZ-4020B	RWZ-6015B	RWZ-6020B	RWZ-6322B	RWZ-6325B	RWZ-8322B	RWZ-8325B	RWZ-13025B
Processing range	3000*1500mm	4000*1500mm	4000*2000mm	6000*1500mm	6000*2000mm	6300*2200mm	6300*2500mm	8300*2200mm	8300*2500mm	13000*2500mm
X-axis travel	1500mm	1500mm	2000mm	1500mm	2000mm	2200mm	2500mm	2200mm	2500mm	2500mm
Y-axis travel	3000mm	4000mm	4000mm	6000mm	6000mm	6300mm	6300mm	8300mm	8300mm	13000mm
Z-axis travel	250mm									
Laser power (W)	1500/2000/3000/4000/6000/8000/10000/12000/15000/20000/30000/others									
X/Y-axis positioning accuracy	≤ ±0.03mm									
X/Y-axis repeat positioning accuracy	≤ ±0.02mm									
Maximum positioning speed	120m/min									

# FIBER LASER CUTTER

Double Drive

## RWZL SERIES

### Closed Type Exchange Table

#### Feature

- Closed processing environment, dust, smoke, radiation, safety and environmental protection.
- Equipped with divisional exhaust system and professional laser exhaust fan.
- Powerful cutting process database supports rapid cutting of all thickness plates.

#### Product Parameter List

Type	RWZL-3015B	RWZL-4015B	RWZL-4020B	RWZL-6015B	RWZL-6020B	RWZL-6322B	RWZL-6325B	RWZL-8322B	RWZL-8325B	RWZL-13025B
Processing range	3000*1500mm	4000*1500mm	4000*2000mm	6000*1500mm	6000*2000mm	6300*2200mm	6300*2500mm	8300*2200mm	8300*2500mm	13000*2500mm
X-axis travel	1500mm	1500mm	2000mm	1500mm	2000mm	2200mm	2500mm	2200mm	2500mm	2500mm
Y-axis travel	3000mm	4000mm	4000mm	6000mm	6000mm	6300mm	6300mm	8300mm	8300mm	13000mm
Z-axis travel	250mm									
Laser power (W)	1500/2000/3000/4000/6000/8000/10000/12000/15000/20000/30000/others									
X/Y-axis positioning accuracy	≤±0.03mm									
X/Y-axis repeat positioning accuracy	≤±0.02mm									
Maximum positioning speed	120m/min									

# FIBER LASER CUTTER

Double Drive

## RWLG SERIES

### Open Type Tube & Plate

#### Feature

- Cuts plates, round tubes, square tubes, and formed boxes.
- Automatic full stroke pneumatic chuck for fast clamping..



#### Product Parameter List

Type	RWLG-3015G	RWLG-4015G	RWLG-4020G	RWLG-6015G	RWLG-6020G	RWLG-6322G	RWLG-6325G	RWLG-8325G	RWLG-13025G
Plate processing range	3000*1500mm	4000*1500mm	4000*2000mm	6000*1500mm	6000*2000mm	6300*2200mm	6300*2500mm	8300*2500mm	13000*2500mm
X-axis travel	1500mm	1500mm	2000mm	1500mm	2000mm	2200mm	2500mm	2500mm	2500mm
Y-axis travel	3000mm	4000mm	4000mm	6000mm	6000mm	6300mm	6300mm	8300mm	13000mm
Z-axis travel					140mm				
Laser power (W)				1500/2000/3000/4000/6000/8000/10000/12000/15000/20000/30000/others					
Cut pipe length					6000mm/9000mm/12000mm/others				
Cutting pipe diameter					Φ165/Φ220/Φ350/others				
X/Y-axis positioning accuracy					≤ ±0.03mm				
X/Y-axis repeat positioning accuracy					≤ ±0.02mm				
Maximum positioning speed					120m/min				

# FIBER LASER CUTTER

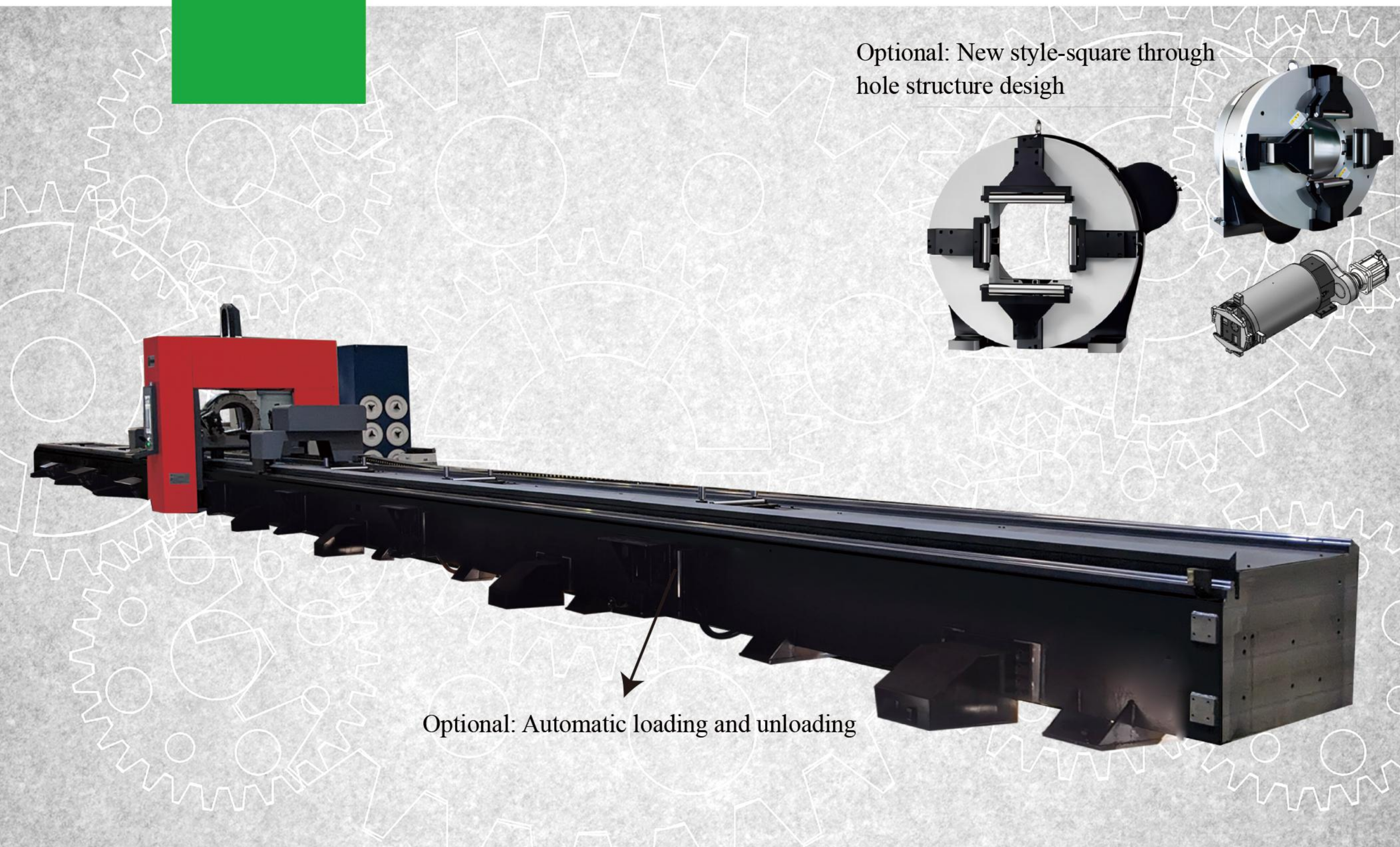

## RWG SERIES

### Professional Tube

#### Feature

- Can cut round, square, rectangular, elliptical pipes.
- One-time forming for 6-meter pipes; optional 9-meter and 12-meter models.
- Automatic full stroke pneumatic chuck: 3x faster than electric chuck.

#### Product Parameter List

Type	RWG-6013G	RWG-6016G	RWG-6022G	RWG-6035G	others
Cut pipe length	6000mm	6000mm	6000mm	6000mm	9000mm/12000mm/others
Cutting pipe diameter	Φ0-130mm	Φ10-160mm	Φ10-220mm	Φ25-350mm	Φ230/520/560/others
Laser power (W)	1500/2000/3000/4000/6000/8000/10000/12000/15000/20000/30000/others				
Positioning accuracy				≤ ±0.03mm	
Repeatability positioning accuracy				≤ ±0.02mm	
Maximum positioning speed				120m/min	
A/P axis rotation				N°360°	

# FIBER LASER CUTTER

## RWG SERIES

### Handheld laser welding head

#### Feature

- Fast welding speed, 2~10 times faster than traditional welding, Easy operating need no training.
- Welding seam beautiful smooth and beautiful, don't need polish, save your time.
- No deformation or welding scar, firm welding of the workpiece.
- Laser welding has less consumables and long service life.

#### Features of the Welding Gun

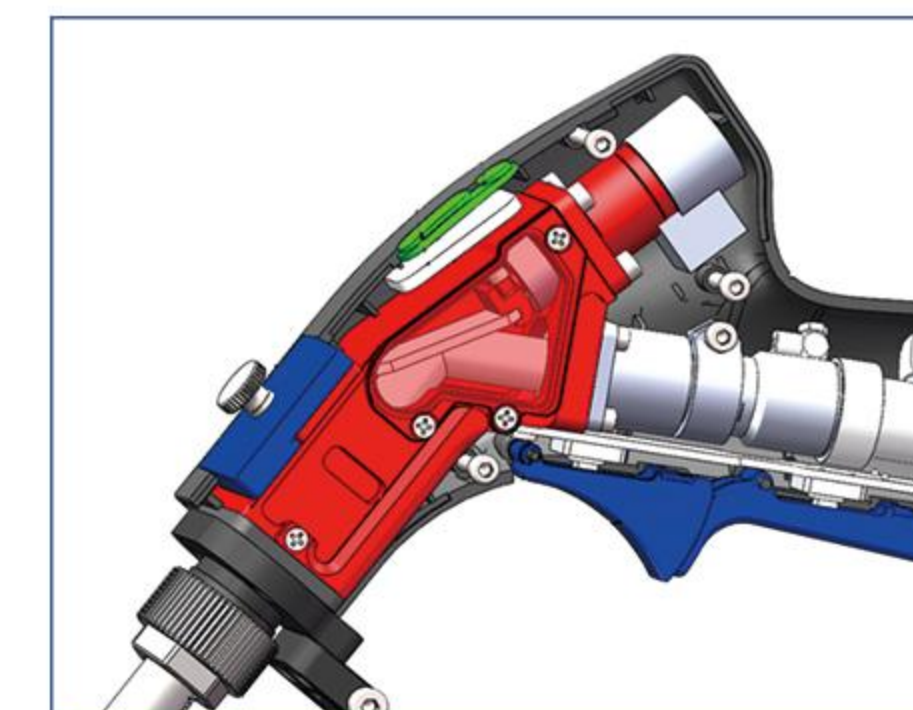

Dual-button

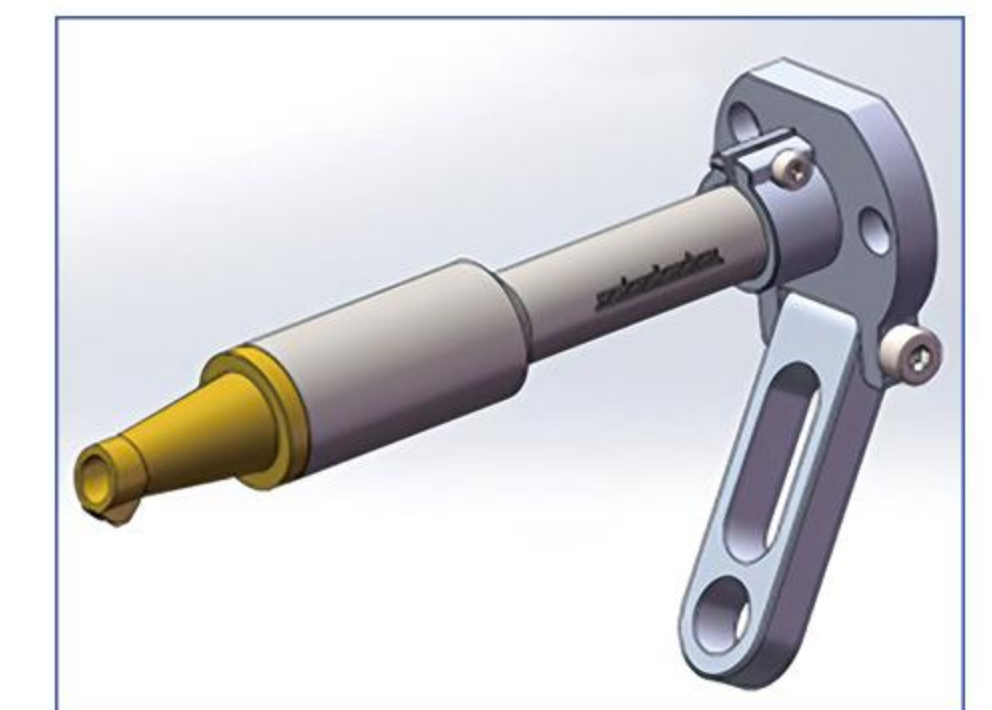

Anti-spatter

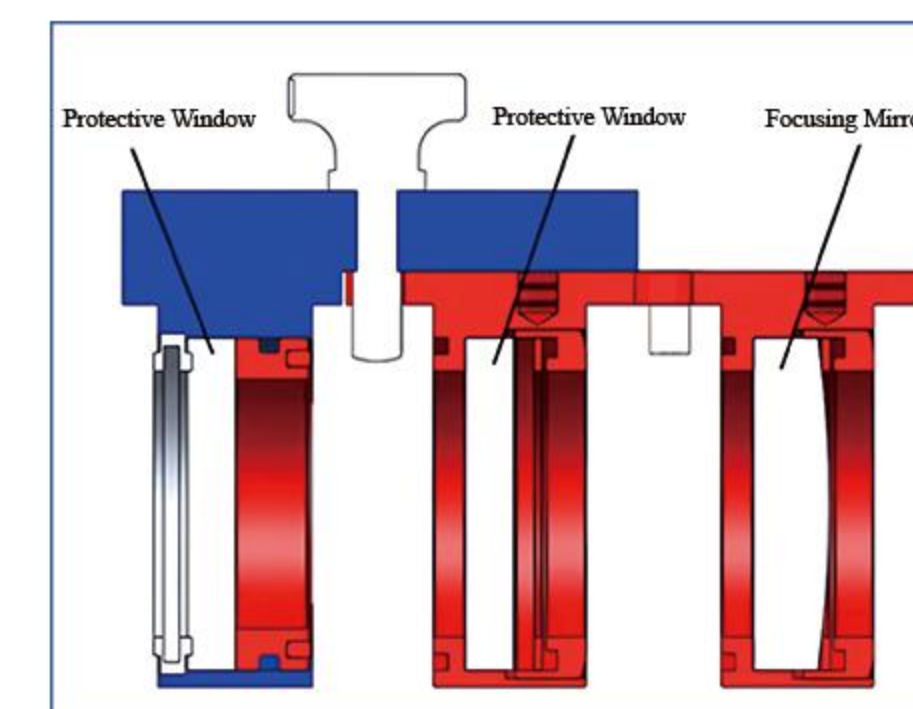

Double protective lenses



PS0 Function



#### Product Parameter List

Type	Handheld laser welding head
Welding Focus Length(mm)	150
Cleaning Focus Length(mm)	500
Welding Beam diameter(mm)	Adjustable (0.5-5)
Cleaning Beam diameter(mm)	Adjustable (0.5-50)
Interface Type	QBH
Accessible wavelength	1070
Weight	0.8kg

# LASER CUT/WELDING

## RWS SERIES

## CNC Three-Dimensional



### Robot laser welding system

Fiber cutting robot cuts various complicated three-dimensional curves freely and flexibly; Adopt flexible fiber laser source that can transfer in a far distance as the transferring media, it won't limit the working path of the robot; Concentrated operation, fast moving and precise processing enhance the cutting quality stably; Reduce the labor intensity and avoid high requirement on the workers' technique and labor cost.

### Robot laser welding system

The six axis linkade can complete arbitrary trajectory in space manipulator and optical fiber transmission laser welding machine perfect combination, can meet all kinds of automatic production needs widely used in automatic welding kitchen, bath, door handle, precision parts, hardware products.

## STANDARD

- Cypcut Laser Cutting System
- High Precision Laser Cutting Head
- Laser Source
- Japan FUJI Brand Servo Motor
- Japan SHIMPO Brand Reducer Motor
- Taiwan HK and HIWIN Linear Guide
- Industrial Machine Bed
- Handheld wireless remote control
- China Hanli Chiller
- Protection mirror/Laser head nozzle/Hexagon wrench

## OPTIONAL

- BOCHU CypCut Laser Cutting Control System
- Germany PRECITEC Cutting Head
- Shanghai BOCHU Cutting Head
- Shanghai EMPOWER Cutting Head
- Germany IPG Laser Resource
- Wuhan RAYCUS Laser Resource
- Shenzhen MAX Laser Resource
- Voltage Stabilizer
- Dust Collector
- Air Compressor

# FIBER LASER CUTTER

Steel plate plug welder rack, with heat treatment to avoid frame deformation within 20 years.





The laser cutting head with auto sensor function is from BOCI / EMPOWER/PRECITEC, which is suitable for different focal lengths and be controlled by the system. For the sheet metal with different thicknesses, the focal point will be automatically adjusted in cutting process to achieve the best cutting effect.

# AUTO FOCUS

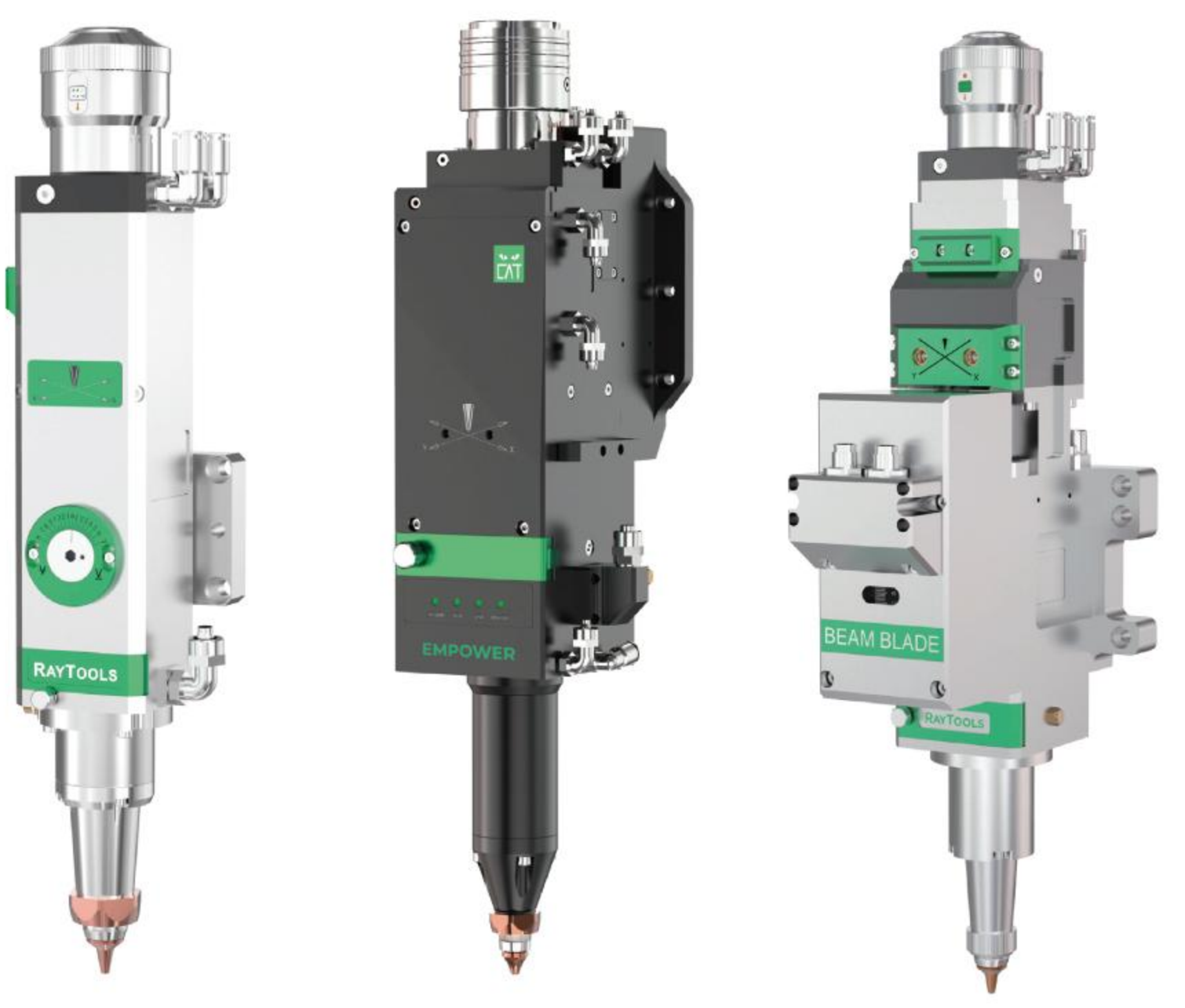



IPG 1000W-8000W



RAYCUS 1000W-8000W



MAX 1000W-8000W

# CNC SYSTEM

## BOCHU CypCut Laser Cutting Control System

### Features

#### Extremely simple operation, powerful functions:

- Graphical interface, novice can learn in 3 days; support batch modification of process parameters, saving debugging time.
- Built-in material process library, covering cutting parameters from 1mm thin plate to 50mm+ thick plate.

#### Intelligent optimization, cost reduction and efficiency improvement:

- Idle path compression: automatic optimization of cutting trajectory, reducing empty running, and improving efficiency by 20%-30%.
- Real-time monitoring and error correction: automatic diagnosis of cutting abnormalities (such as focus offset) and triggering of protection mechanism.

#### Open compatibility, worry-free expansion:

- Support mainstream brand lasers and machine tools, no barriers to software and hardware collaboration.
- Modular software upgrade, expand functions on demand (such as adding new pipe types or cutting processes).

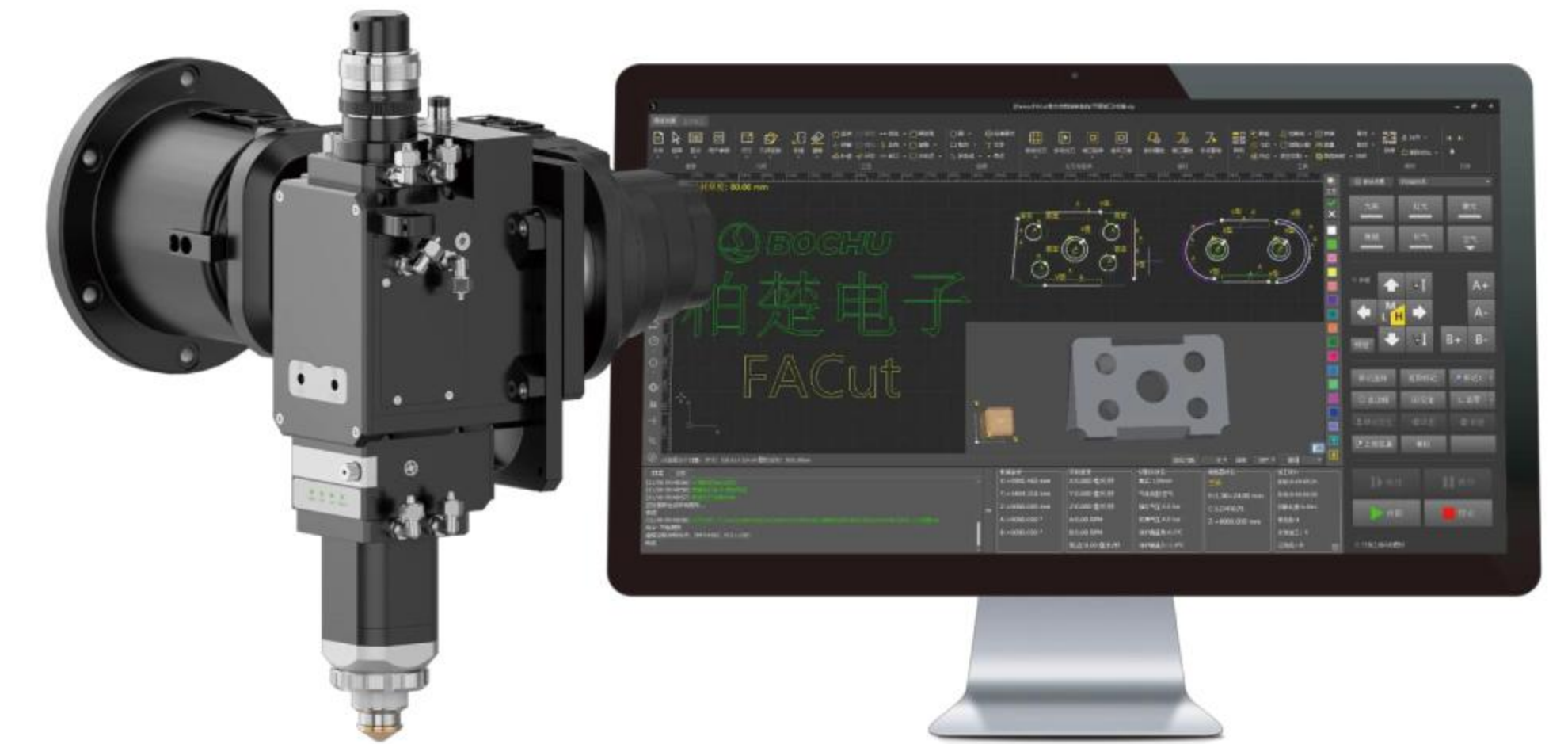
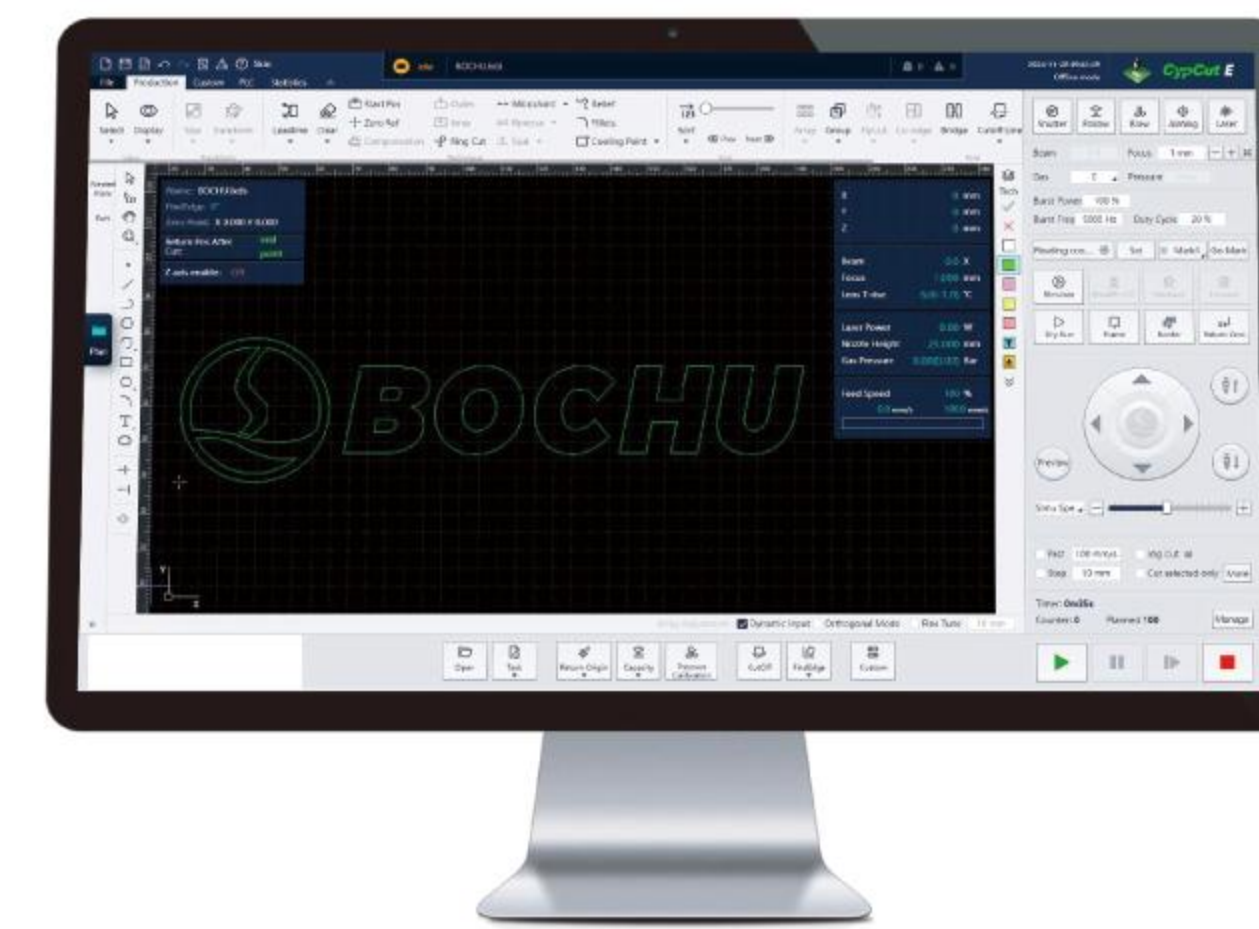

### Automatic Sheet Cutting



### Automatic Tube Cutting

# FLEXIBLE PRODUCTION LINE E



# FLEXIBLE PRODUCTION LINE

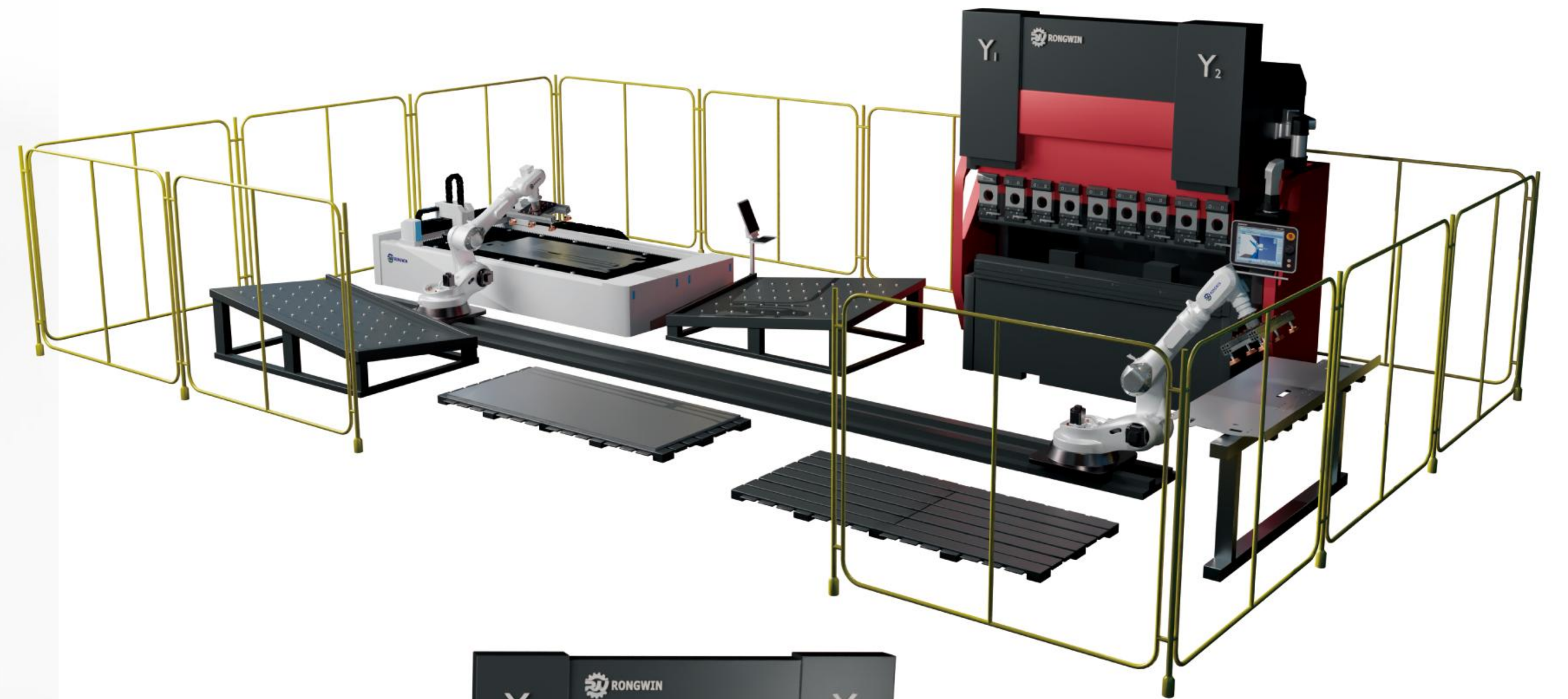

# LASER CUTTING CAPACITY

- Stainless Steel
- Carbon Steel
- Aluminum Alloy
- Brass Alloy

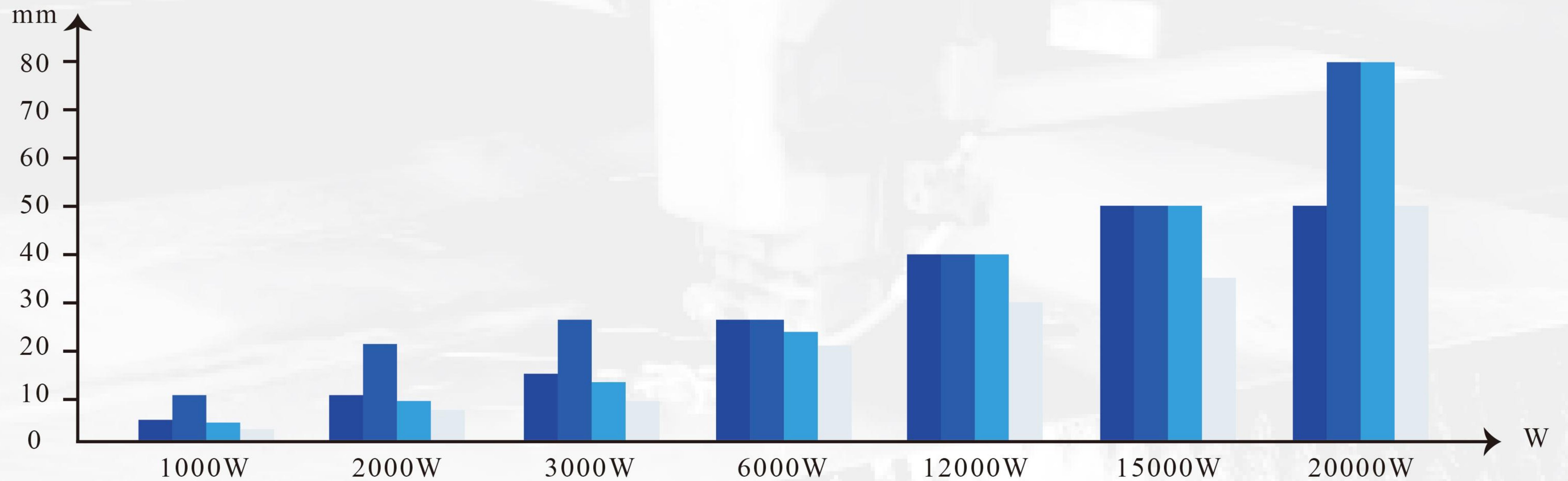

# WORKPIECE DISPLAY



# CONTACT US

---

## Nanjing RONGWIN Machinery Technology Co., Ltd.

Marketing: [info@rongwin.com](mailto:info@rongwin.com)

Service: [service@rongwin.com](mailto:service@rongwin.com)

Tel: 0086-(0)25-57226860

Web: [www.rongwin.com](http://www.rongwin.com)

Mob/WhatsApp: 0086-15156147667

Mob/WhatsApp: 0086-15212339345

Fax: 0086-(0)25-57431680

[www.metalworkmaster.com](http://www.metalworkmaster.com)

Marketing Address:

Headquater :

Technology and Innovation Center, Lishui Industry, New Town, Lishui Economic Development Zone, Nanjing, Jiangsu, China 211200

Factory Address:

No. 105, Liaohe East Road, Bowang Town, Bowang District, Ma'anshan City, Anhui Province China Zip Code : 243131

